

# WELLSBORO ELECTRIC COMPANY

P.O. BOX 138 , 33 AUSTIN STREET  
WELLSBORO , PENNSYLVANIA 16901  
(570) 724 - 3516

## INSTALLATION REQUIREMENTS OF UNDERGROUND - POLE / POST MOUNTED SERVICES FOR MOBILE HOMES AND SIMILIAR APPLICATIONS

### IMPORTANT:

ALL INSTALLATIONS MUST BE INSPECTED AND APPROVED BY A RECOGNIZED INSPECTION AGENCY BEFORE THE SERVICE CAN BE ENERGIZED.

ALL INSTALLATIONS TO BE IN ACCORDANCE WITH THE NATIONAL ELECTRIC CODE

DITCH MUST BE INSPECTED BY WELLSBORO ELECTRIC PERSONNEL PRIOR TO BACKFILLING

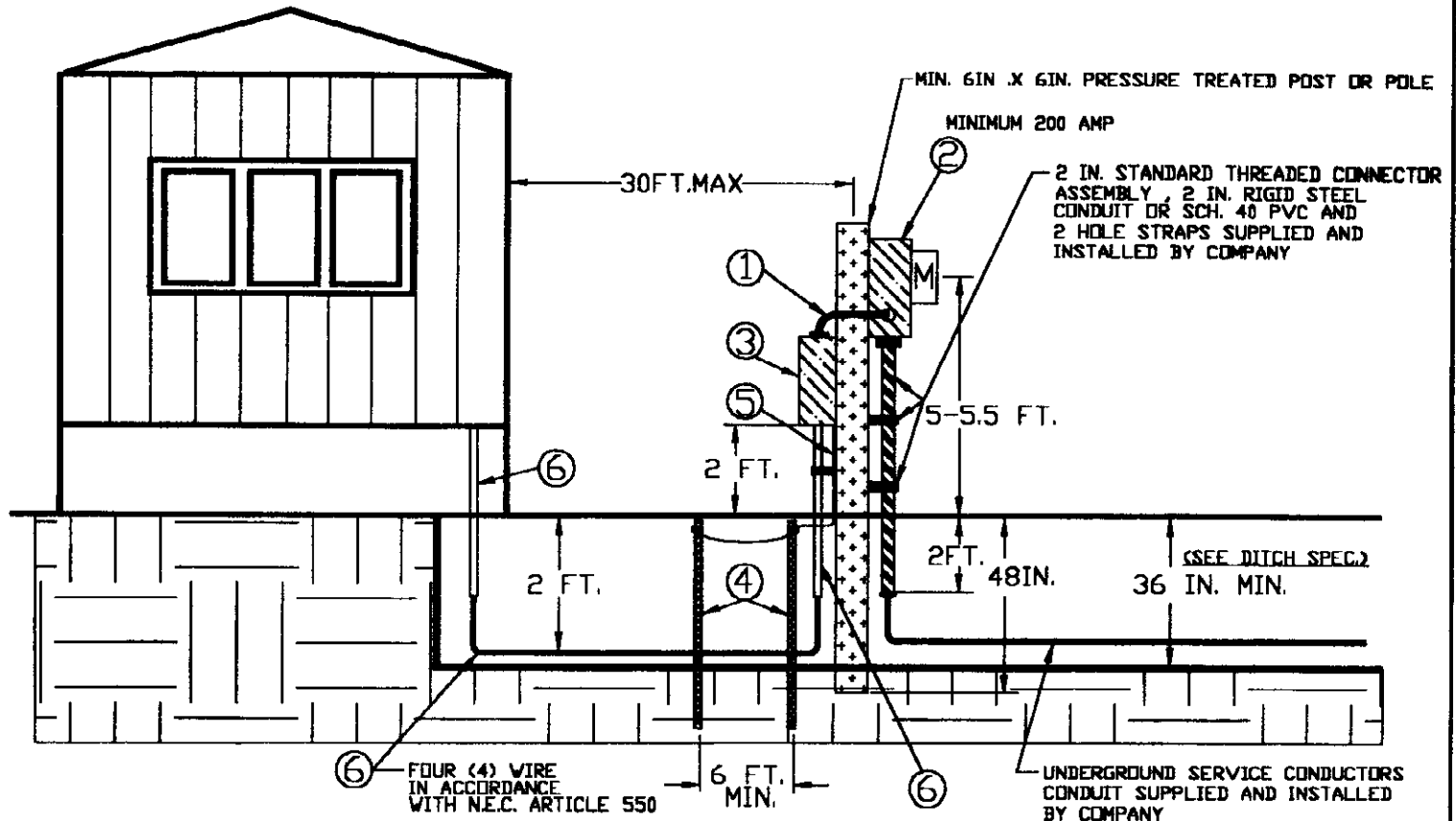

### FURNISHED AND INSTALLED BY CUSTOMER

- ① CUSTOMER OWNED SERVICE ENTRANCE CABLE OR SERVICE ENTRANCE CONDUCTORS IN APPROVED CONDUIT.  
100 AMP - # 2 ALUMINIUM OR # 4 COPPER  
200 AMP - 4/0 ALUMINIUM OR 2/0 COPPER
- ② CUSTOMER OWNED 4 JAW UL APPROVED RINGLESS TYPE METERBASE WITH WEATHER TIGHT HUBS AND BY-PASS HORNS EITHER PURCHASED FROM COMPANY OR ELECTRICAL SUPPLY COMPANY. DO NOT USE BOTTOM CENTER KNOCKOUT
- ③ CUSTOMER OWNED SERVICE EQUIPMENT - MINIMUM 100 AMP WITH 6 BREAKER SPACES MINIMUM.
- ④ TWO (2) 5/8 IN. X 8 FT. COPPERWELD OR GALVANIZED GROUND RODS SPACED A MINIMUM OF 6 FT. APART.
- ⑤ GROUND WIRE # 6 BARE COPPER FOR 100 AMP INSTALLATION AND # 4 BARE COPPER FOR A 200 AMP INSTALLATION. WHERE AVAILABLE , SERVICE SHOULD ALSO BE GROUNDED TO WELL CASING OR UNDERGROUND METALLIC WATER PIPING SYSTEM. GAS OR FUEL OIL PIPING SHALL NOT BE USED AS A GROUNDING ELECTRODE. BONDING SEE N.E.C. ARTICLE 250
- ⑥ CUSTOMER SUPPLIED/INSTALLED CONDUIT WITH 4 WIRE CABLE AT MINIMUM DEPTH OF 2 FEET PRIOR TO INSPECTION.

W-E14B  
01/2001

# SPECIFICATIONS FOR UNDERGROUND SERVICE INSTALLATION

- 1 THE OWNER (CUSTOMER) MUST DIG THE DITCH TO COMPANY SPECIFICATION.
- 2 DITCH LENGTH (MUST BE LESS THAN 150 FEET) AND ROUTING MUST BE EXACTLY AS SPECIFIED BY THE COMPANY AND MUST BE AS SHORT AND DIRECT AS POSSIBLE BETWEEN METER LOCATION AND THE DESIGNATED POLE.
- 3 THE ENTIRE LENGTH OF THE DITCH MUST BE AT LEAST THREE (3) FEET DEEP AND FREE OF LARGE OR SHARP ROCKS.
- 4 AFTER THE DITCH HAS BEEN INSPECTED BY THE COMPANY FOR PROPER DITCH DEPTH, LENGTH, PROPER CONDUIT AND PULL ROPE INSTALLATION THE DITCH MAY THEN BE BACKFILLED LEAVING FIVE (5) FOOT ON EACH END SO AS TO ALLOW FOR CABLE INSTALLATION.
- 5 THE UNDERGROUND WARNING TAPE IS SUPPLIED BY COMPANY AND INSTALLED BY OWNER (CUSTOMER) IN THE TOP FOOT OF SOIL—SEE DRAWING BELOW.
- 6 TELEPHONE AND OTHER COMMUNICATION CABLES MAY BE PLACED IN THE SAME DITCH AT ONE FOOT ABOVE THE UNDERGROUND SERVICE CABLE.
- 7 AFTER THE ELECTRICAL SERVICE IS INSPECTED AND APPROVED AND ALL REQUIREMENTS ARE MET, THE COMPANY WILL INSTALL THE UNDERGROUND CABLE AND ENERGIZE THE SERVICE.
- 8 WATER OR GAS LINES ARE NOT PERMITTED IN THE SAME DITCH.
- 9 THE LOCATION OF THE UNDERGROUND MUST BE MARKED; SINCE MOST OUTAGES ON UNDERGROUND SERVICES ARE CAUSED BY "DIG-UPS" WHICH ARE COSTLY AS WELL AS INCONVENIENT.
- 10 THE PENNSYLVANIA ONE CALL SYSTEM, INC. 1 (800) - 242 - 1776 CAN BE CONTACTED FOR ANY WORK DONE ON THE PROPERTY TO: DIG, DRILL, BLAST, AUGER, BORE, GRADE, TRENCH OR DEMOLISH WORK ANYWHERE IN THE COMMONWEALTH REQUIRING 3 WORKING DAYS NOTICE FROM OWNER (CUSTOMER) OR EXCAVATOR.
- 11 FOR ANY REASON IT BECOMES NECESSARY TO REPAIR OR REPLACE THE UNDERGROUND CABLE, THE OWNER (CUSTOMER) SHALL BE RESPONSIBLE FOR EXPENSES AND ARRANGING OF THE RE-OPENING AND RE-CLOSING PART OR ALL OF THE DITCH, REGARDLESS OF THE REASON THE CABLE BECAME DEFECTIVE. THE REPLACEMENT CABLE OR REPAIRS TO THE EXISTING CABLE WILL BE FURNISHED AND INSTALLED AT NO CHARGE TO THE OWNER (CUSTOMER) PROVIDED DAMAGE WAS NOT CAUSED BY OWNER (CUSTOMER).

W-E16B  
01/2001

DITCH MUST BE INSPECTED BY WELLSBORO ELECTRIC PERSONNEL PRIOR TO BACKFILLING

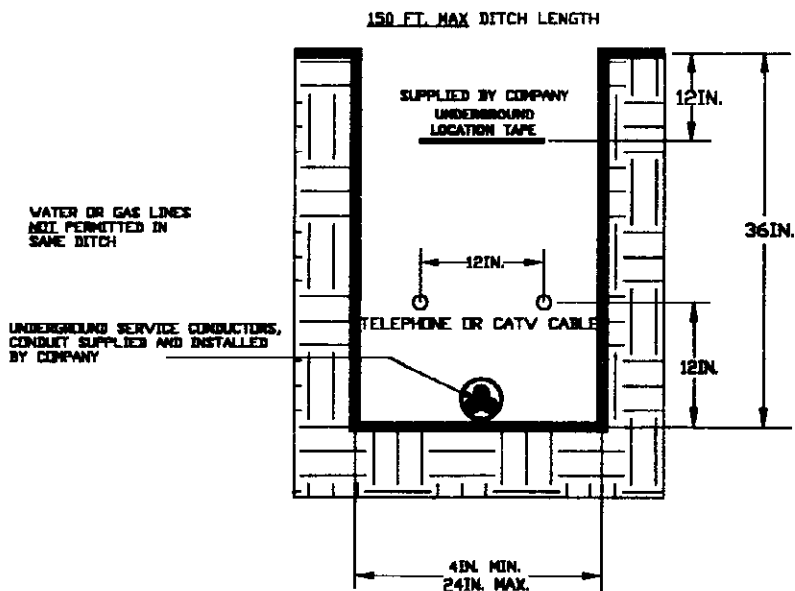

**200 AMP UNDERGROUND METERBASE REGULAR**

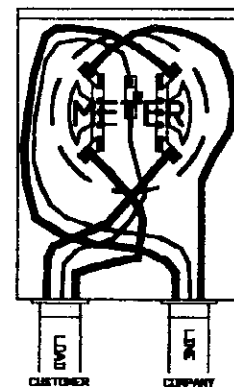

**200 AMP UNDERGROUND METERBASE WITH SIDE WIRE SPACE**

